

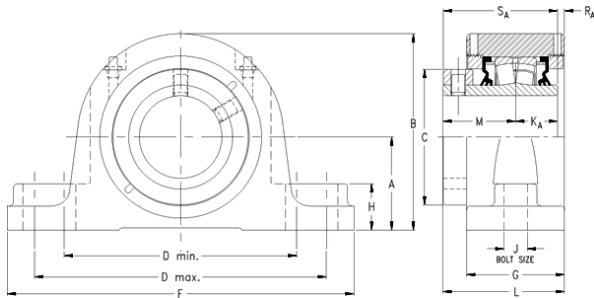

HMSA BEARING MANUFACTURING LIMITED



timken QAPL20A315S Solid Block/Spherical Roller Bearing Housed Units-Single Concentric Two-Bolt Pillow Block

Bearing No. QAPL20A315S

QAPL20A315S Bearing 2D drawings and 3D CAD models

Engineering Group	Mounted Bearing
Shaft Size	3-15/16 in
Shaft Size Type	Imperial
Full Timken Part Number	QAPL20A315SB
Locking Style	Single Concentric
Weight	59.0 lb
Housing Style	Two-Bolt Pillow Block
UPC Code	0883450048309
Dimension A	4.25 in
Dimension B	8.38 in
Dimension C	6.00 in
Dimension D Max	12.60 in
Dimension D Min	10.04 in
Dimension F	14.25 in
Dimension G	3.730 in
Dimension H	2.13 in
Dimension J (Bolt Size)	1.000 in
Dimension KA	1.63 in
Dimension L	4.84 in
Dimension M	2.97 in
Dimension RA	0.24 in
Dimension SA	4.60 in
C0 - Static Load	113000 lb
C - Dynamic Load (Basic)	97700 lb
e - Geometry Factor	0.24



HMSA BEARING MANUFACTURING LIMITED

Y1 - Geometry Factor	2.85
Y2 - Geometry Factor	4.24
Oil Lubrication - M/N Seal	1200 rpm
Oil Lubrication - T Seal	2000 rpm
Oil Lubrication - B/C/O Seal	900 rpm
Grease Lubrication - M/N Seal	1200 rpm
Grease Lubrication - T Seal	1600 rpm
Grease Lubrication - B/C/O Seal	900 rpm
Float	0.083 in
Shaft Tolerance	0.0030 in
Eng Internal Radial Clearance - Min	0.0030
Eng Internal Radial Clearance - Max	0.0047
Pre Install Clearance Min	0.0030 in
Pre Install Clearance Max	0.0047 in