

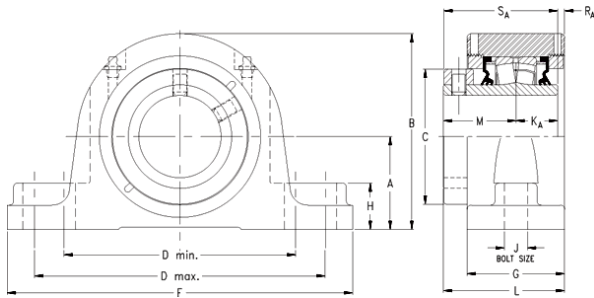

HMSA BEARING MANUFACTURING LIMITED



timken QASN10A115S Solid Block/Spherical Roller Bearing Housed Units-Single Concentric Two-Bolt Pillow Block

Bearing No. QASN10A115S

QASN10A115S Bearing 2D drawings and 3D CAD models

Engineering Group	Mounted Bearing
Shaft Size	1-15/16 in
Shaft Size Type	Imperial
Full Timken Part Number	QASN10A115SB
Locking Style	Single Concentric
Weight	28 lb
Housing Style	Two-Bolt Pillow Block
UPC Code	0883450352840
Dimension A	2.76 in
Dimension B	5.35 in
Dimension C	2.87 in
Dimension D Max	8.50 in
Dimension D Min	7.20 in
Dimension F	10.00 in
Dimension G	2.680 in
Dimension H	0.98 in
Dimension J (Bolt Size)	0.625 in
Dimension KA	1 in
Dimension L	3.23 in
Dimension M	1.89 in
Dimension RA	0.35 in
Dimension SA	2.87 in
C0 - Static Load	26600 lb
C - Dynamic Load (Basic)	26300 lb
e - Geometry Factor	0.24



HMSA BEARING MANUFACTURING LIMITED

Y1 - Geometry Factor	2.84
Y2 - Geometry Factor	4.23
Oil Lubrication - M/N Seal	2400 rpm
Oil Lubrication - T Seal	4200 rpm
Oil Lubrication - B/C/O Seal	1800 rpm
Grease Lubrication - M/N Seal	2400 rpm
Grease Lubrication - T Seal	3550 rpm
Grease Lubrication - B/C/O Seal	1800 rpm
Float	0.050 in
Shaft Tolerance	0.0015 in
Eng Internal Radial Clearance - Min	0.0016
Eng Internal Radial Clearance - Max	0.0026
Pre Install Clearance Min	0.0016 in
Pre Install Clearance Max	0.0026 in